

**Rural Municipality of
Edenwold No. 158**



This is the Zoning District Map referred to in Bylaw 2019-20 adopted by the Rural Municipality of Edenwold No. 158

Key Map

Saskatchewan

Date: January 12th, 2024

LEGEND:

- Contract Zone
- First Nation Reserves
- Highway
- Railway
- Urban Municipalities
- Watercourse
- Waterbody
- Recreation Area
- Buried Distribution Line
- Compressor Station
- Gas Cavern
- R.M. Boundary

ZONING DISTRICTS:

- Potentially Hazardous Lands
- AR - Agricultural Resource
- CR1 - Country Residential 1
- CR2 - Country Residential 2
- CR3 - Country Residential 3
- R1 - Urban Residential 1
- R2 - Urban Residential 2
- R3 - Urban Residential 3
- RMH - Residential Manufactured Home
- CS - Community Service
- SC - Shopping Centre
- HPC - High Profile Commercial
- COM1 - General Commercial
- IND1 - General Industrial
- EHI - Extraction & Heavy Industrial
- FD - Future Development
- DCD - Direct Control Districts:
 - DCD1 - Zehner
 - DCD2 - Richardson
 - DCD3 - Kathrinthal
 - DCD4 - Jameson

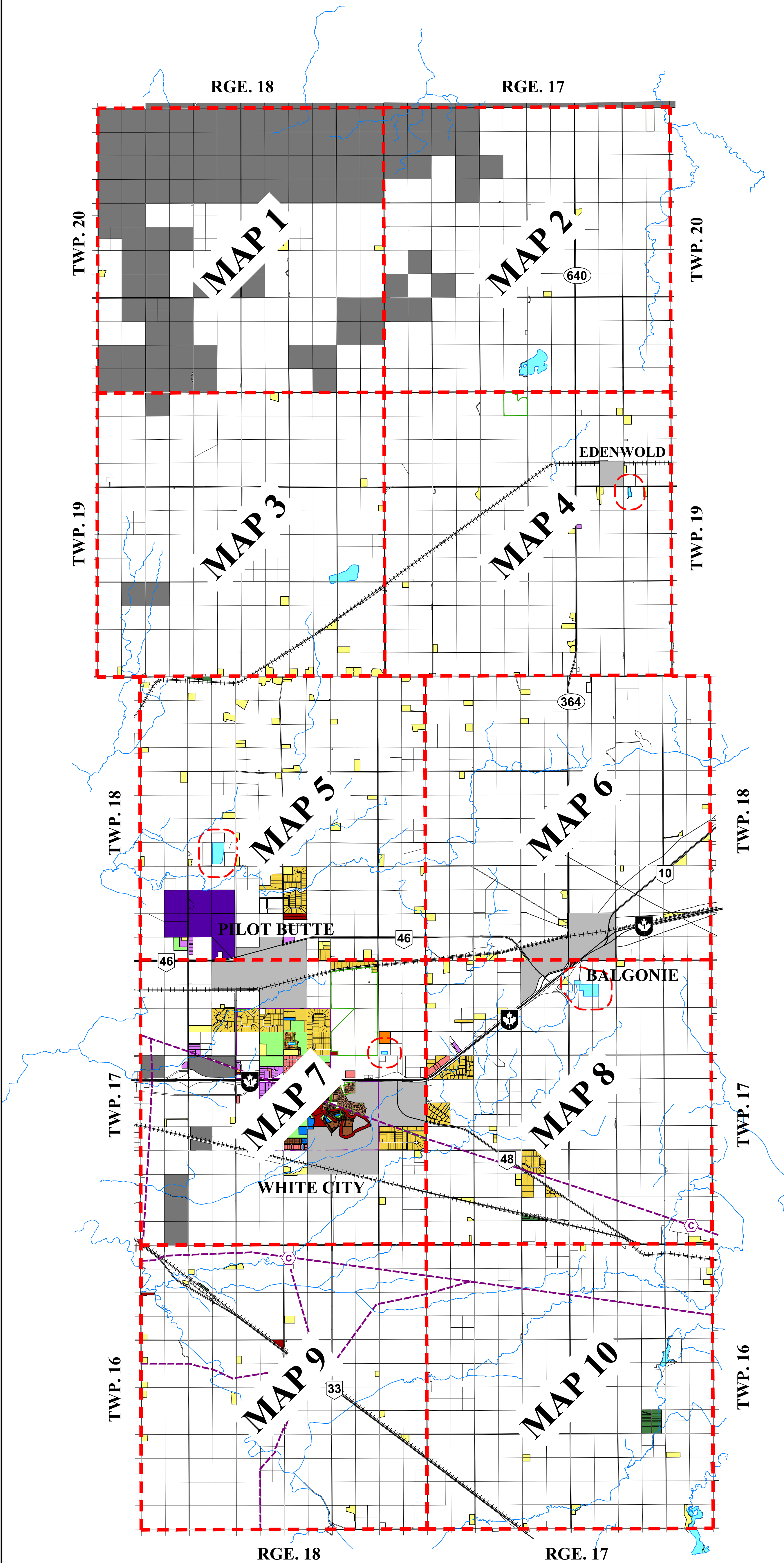

Note: The information contained on this map is for reference only.

Scale - 1:75,000



GeoVerra Inc.
Toll Free: 1-800-465-6233
www.geoverra.com

Initials: RH - SA / MDB
Client File:
Job No.: 21-A0360-003 (209466)
Drawing No.: 21-A0360-003-RM_R4

Rural Municipality of Edenwold No. 158



This is the Zoning District Map referred to in Bylaw 2019-20 adopted by the Rural Municipality of Edenwold No. 158

Zoning Map 1

Twp. 20 - Rge. 18 - W.2Mer.

Saskatchewan

Date: January 12th, 2024

LEGEND:

- Contract Zone
- First Nation Reserves
- Highway
- Railway
- Urban Municipalities
- Watercourse
- Waterbody
- Recreation Area
- Buried Distribution Line
- Compressor Station
- Gas Cavern
- R.M. Boundary

ZONING DISTRICTS:

- Potentially Hazardous Lands
- AR - Agricultural Resource
- CR1 - Country Residential 1
- CR2 - Country Residential 2
- CR3 - Country Residential 3
- R1 - Urban Residential 1
- R2 - Urban Residential 2
- R3 - Urban Residential 3
- RMH - Residential Manufactured Home
- CS - Community Service
- SC - Shopping Centre
- HPC - High Profile Commercial
- COM1 - General Commercial
- IND1 - General Industrial
- EHI - Extraction & Heavy Industrial
- FD - Future Development

Note: The information contained on this map is for reference only.

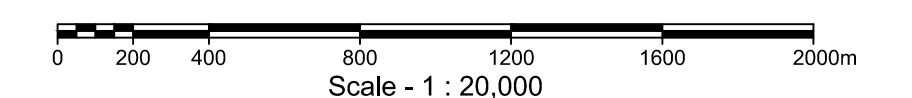

GeoVerra Inc.
Toll Free: 1-800-465-6233
www.geoverra.com

Initials: RH - SA / MDB
Client File:
Job No.: 21-A0360-003 (209466)
Drawing No.: 21-A0360-003-RM_R4

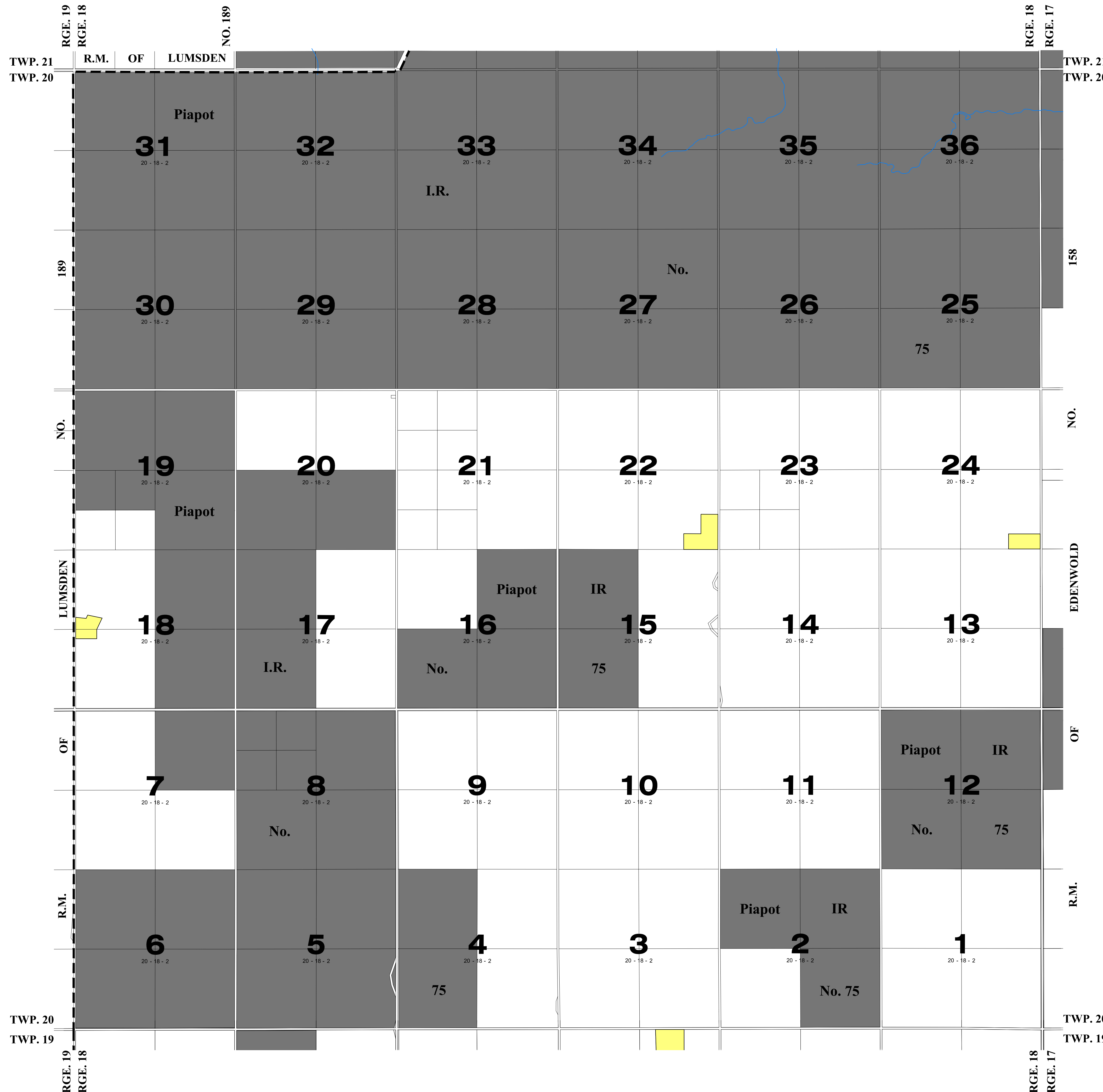

Rural Municipality of Edenwold No. 158



This is the Zoning District Map referred to in Bylaw 2019-20 adopted by the Rural Municipality of Edenwold No. 158

Zoning Map 2

Twp. 20 - Rge. 17 - W.2Mer.

Saskatchewan

Date: January 12th, 2024

LEGEND:

- Contract Zone
- First Nation Reserves
- Highway
- Railway
- Urban Municipalities
- Watercourse
- Waterbody
- Recreation Area
- Buried Distribution Line
- Compressor Station
- Gas Cavern
- R.M. Boundary

ZONING DISTRICTS:

- Potentially Hazardous Lands
- AR - Agricultural Resource
- CR1 - Country Residential 1
- CR2 - Country Residential 2
- CR3 - Country Residential 3
- R1 - Urban Residential 1
- R2 - Urban Residential 2
- R3 - Urban Residential 3
- RMH - Residential Manufactured Home
- CS - Community Service
- SC - Shopping Centre
- HPC - High Profile Commercial
- COM1 - General Commercial
- IND1 - General Industrial
- EHI - Extraction & Heavy Industrial
- FD - Future Development

Note: The information contained on this map is for reference only.

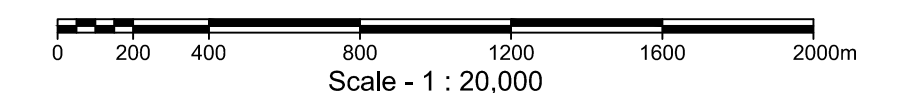

GeoVerra Inc.
Toll Free: 1-800-465-6233
www.geoverra.com

Initials: RH - SA / MDB
Client File:
Job No.: 21-A0360-003 (209466)
Drawing No.: 21-A0360-003-RM_R4

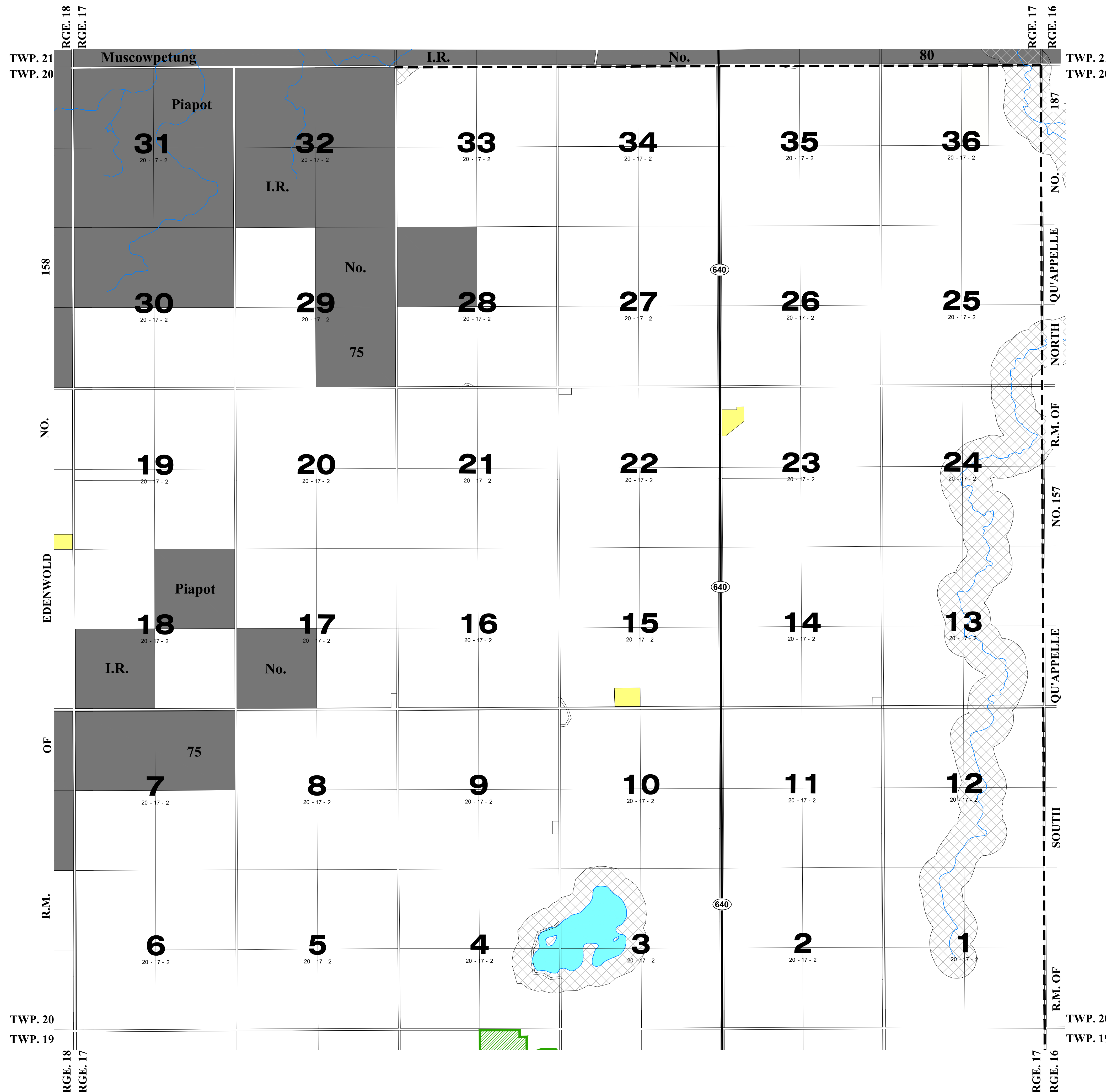

Rural Municipality of Edenwold No. 158



This is the Zoning District Map referred to in Bylaw 2019-20 adopted by the Rural Municipality of Edenwold No. 158

Zoning Map 3

Twp. 19 - Rge. 18 - W.2Mer.

Saskatchewan

Date: January 12th, 2024

LEGEND:

- Contract Zone
- First Nation Reserves
- Highway
- Railway
- Urban Municipalities
- Watercourse
- Waterbody
- Recreation Area
- Buried Distribution Line
- Compressor Station
- Gas Cavern
- R.M. Boundary

ZONING DISTRICTS:

- Potentially Hazardous Lands
- AR - Agricultural Resource
- CR1 - Country Residential 1
- CR2 - Country Residential 2
- CR3 - Country Residential 3
- R1 - Urban Residential 1
- R2 - Urban Residential 2
- R3 - Urban Residential 3
- RMH - Residential Manufactured Home
- CS - Community Service
- SC - Shopping Centre
- HPC - High Profile Commercial
- COM1 - General Commercial
- IND1 - General Industrial
- EHI - Extraction & Heavy Industrial
- FD - Future Development
- Direct Control District 1 - Zehner

Note: The information contained on this map is for reference only.

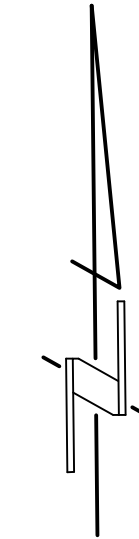
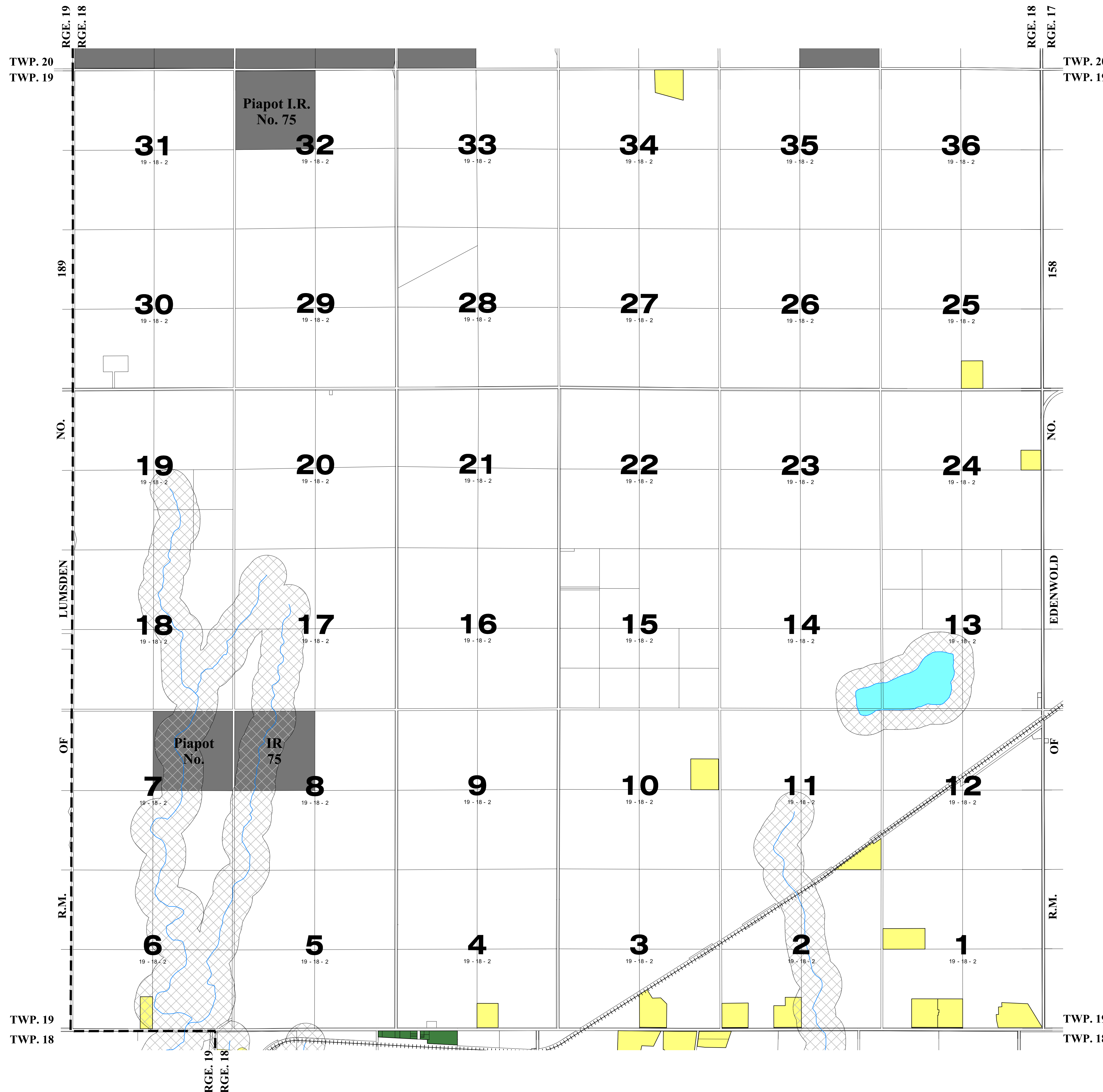
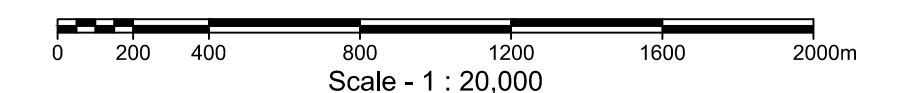

Rural Municipality of Edenwold No. 158



This is the Zoning District Map referred to in Bylaw 2019-20 adopted by the Rural Municipality of Edenwold No. 158

Zoning Map 4

Twp. 19 - Rge. 17 - W.2Mer.

Saskatchewan

Date: January 12th, 2024

LEGEND:

- Contract Zone
- First Nation Reserves
- Highway
- Railway
- Urban Municipalities
- Watercourse
- Waterbody
- Recreation Area
- Buried Distribution Line
- Compressor Station
- Gas Cavern
- R.M. Boundary

ZONING DISTRICTS:

- Potentially Hazardous Lands
- AR - Agricultural Resource
- CR1 - Country Residential 1
- CR2 - Country Residential 2
- CR3 - Country Residential 3
- R1 - Urban Residential 1
- R2 - Urban Residential 2
- R3 - Urban Residential 3
- RMH - Residential Manufactured Home
- CS - Community Service
- SC - Shopping Centre
- HPC - High Profile Commercial
- COM1 - General Commercial
- IND1 - General Industrial
- EHI - Extraction & Heavy Industrial
- FD - Future Development

Note: The information contained on this map is for reference only.

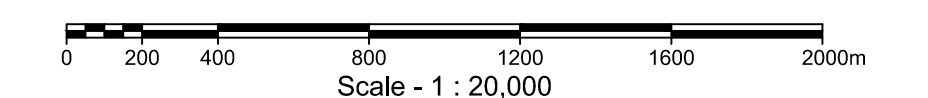

GeoVerra Inc.
Toll Free: 1-800-465-6233
www.geoverra.com

Initials: RH - SA / MDB
Client File:
Job No.: 21-A0360-003 (209466)
Drawing No.: 21-A0360-003-RM_R4

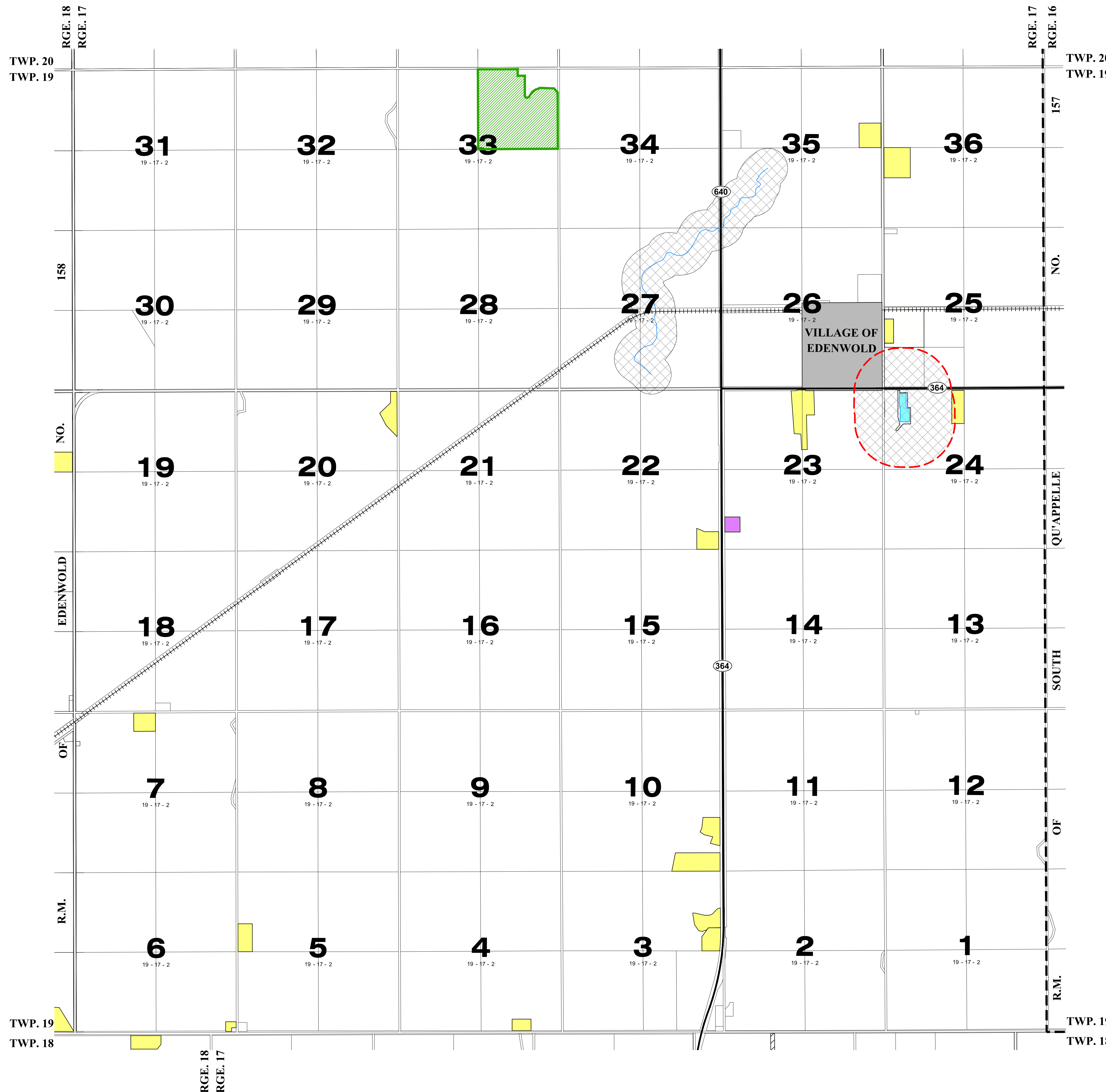

Rural Municipality of Edenwold No. 158



This is the Zoning District Map referred to in Bylaw 2019-20 adopted by the Rural Municipality of Edenwold No. 158

Zoning Map 5

Twp. 18 - Rge. 18 - W.2Mer.

Saskatchewan

Date: January 12th, 2024

LEGEND:

- Contract Zone
- First Nation Reserves
- Highway
- Railway
- Urban Municipalities
- Watercourse
- Waterbody
- Recreation Area
- Buried Distribution Line
- Compressor Station
- Gas Cavern
- R.M. Boundary

ZONING DISTRICTS:

- Potentially Hazardous Lands
- AR - Agricultural Resource
- CR1 - Country Residential 1
- CR2 - Country Residential 2
- CR3 - Country Residential 3
- R1 - Urban Residential 1
- R2 - Urban Residential 2
- R3 - Urban Residential 3
- RMH - Residential Manufactured Home
- CS - Community Service
- SC - Shopping Centre
- HPC - High Profile Commercial
- COM1 - General Commercial
- IND1 - General Industrial
- EHI - Extraction & Heavy Industrial
- FD - Future Development
- Direct Control District 1 - Zehner

Note: The information contained on this map is for reference only.

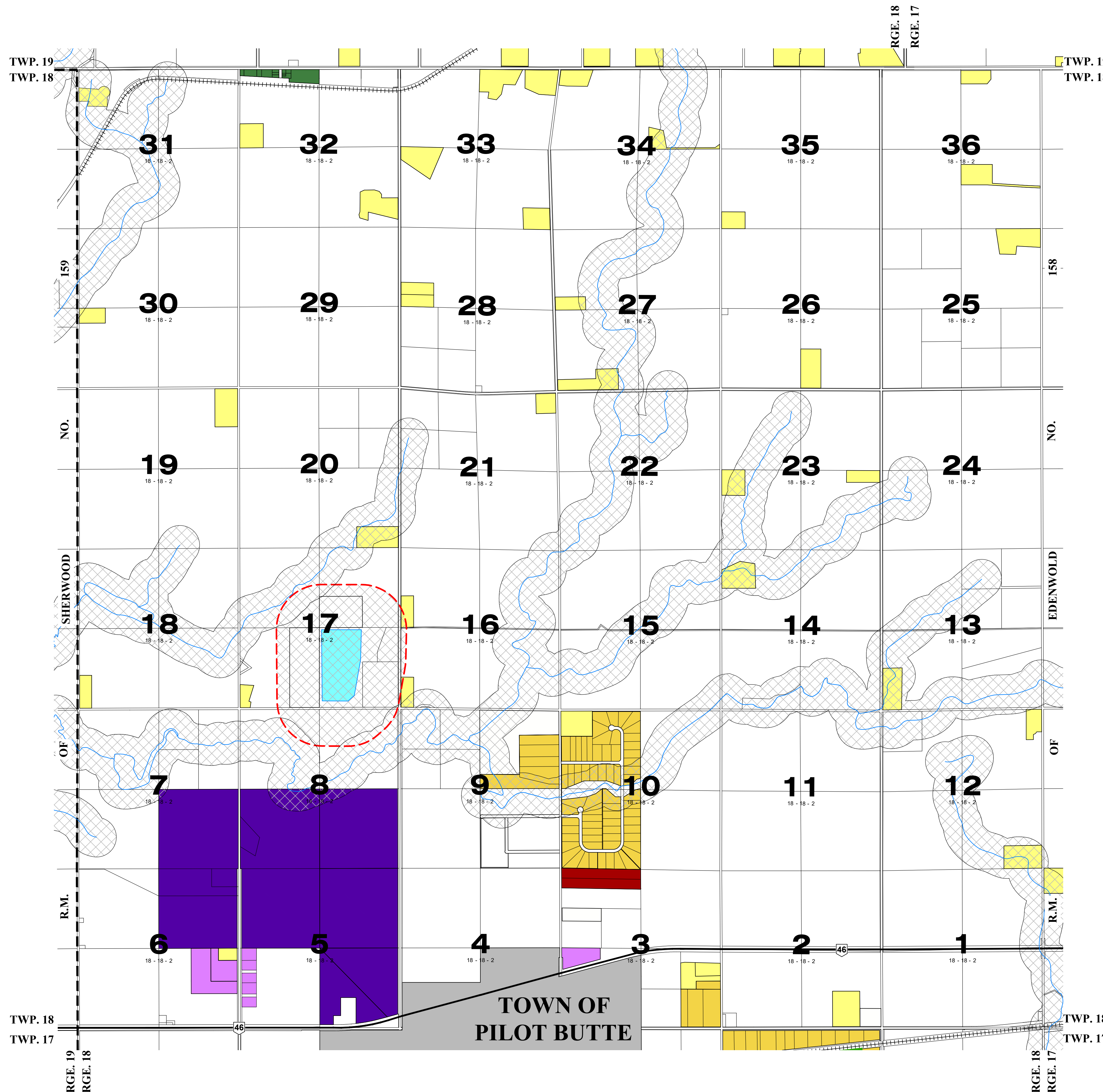
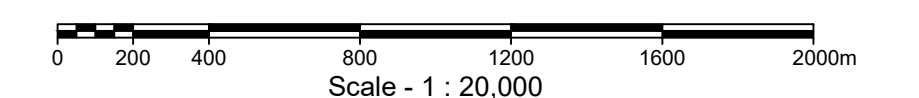

GeoVerra Inc.
Toll Free: 1-800-465-6233
www.geoverra.com

Initials: RH / SA / MDB
Client File:
Job No.: 21-A0360-003 (209466)
Drawing No.: 21-A0360-003-RM_R4

Rural Municipality of Edenwold No. 158



This is the Zoning District Map referred to in Bylaw 2019-20 adopted by the Rural Municipality of Edenwold No. 158

Zoning Map 6

Twp. 18 - Rge. 17 - W.2Mer.

Saskatchewan

Date: January 12th, 2024

LEGEND:

- Contract Zone
- First Nation Reserves
- Highway
- Railway
- Urban Municipalities
- Watercourse
- Waterbody
- Recreation Area
- Buried Distribution Line
- Compressor Station
- Gas Cavern
- R.M. Boundary

ZONING DISTRICTS:

- Potentially Hazardous Lands
- AR - Agricultural Resource
- CR1 - Country Residential 1
- CR2 - Country Residential 2
- CR3 - Country Residential 3
- R1 - Urban Residential 1
- R2 - Urban Residential 2
- R3 - Urban Residential 3
- RMH - Residential Manufactured Home
- CS - Community Service
- SC - Shopping Centre
- HPC - High Profile Commercial
- COM1 - General Commercial
- IND1 - General Industrial
- EHI - Extraction & Heavy Industrial
- FD - Future Development
- Direct Control District 1 - Zehner

Note: The information contained on this map is for reference only.

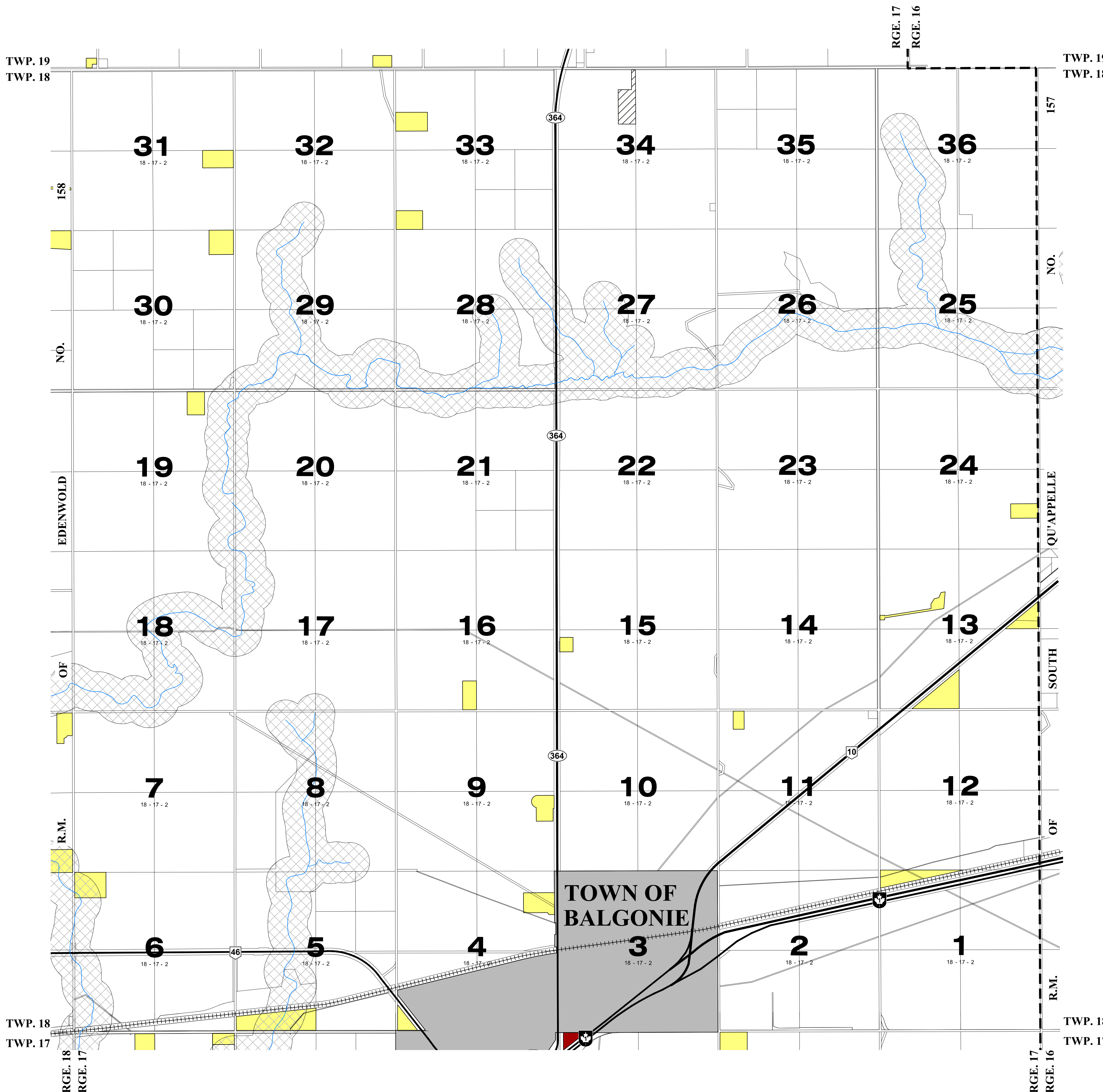
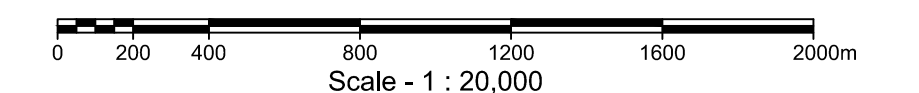

Rural Municipality of Edenwold No. 158



This is the Zoning District Map referred to in Bylaw 2019-20 adopted by the Rural Municipality of Edenwold No. 158

Zoning Map 7

Twp. 17 - Rge. 18 - W.2Mer.

Saskatchewan

Date: January 12th, 2024

LEGEND:

- Contract Zone
- First Nation Reserves
- Highway
- Railway
- Urban Municipalities
- Watercourse
- Waterbody
- Recreation Area
- Buried Distribution Line
- Compressor Station
- Gas Cavern
- R.M. Boundary

ZONING DISTRICTS:

- Potentially Hazardous Lands
- AR - Agricultural Resource
- CR1 - Country Residential 1
- CR2 - Country Residential 2
- CR3 - Country Residential 3
- R1 - Urban Residential 1
- R2 - Urban Residential 2
- R3 - Urban Residential 3
- RMH - Residential Manufactured Home
- CS - Community Service
- SC - Shopping Centre
- HPC - High Profile Commercial
- COM1 - General Commercial
- IND1 - General Industrial
- EHI - Extraction & Heavy Industrial
- FD - Future Development

Note: The information contained on this map is for reference only.

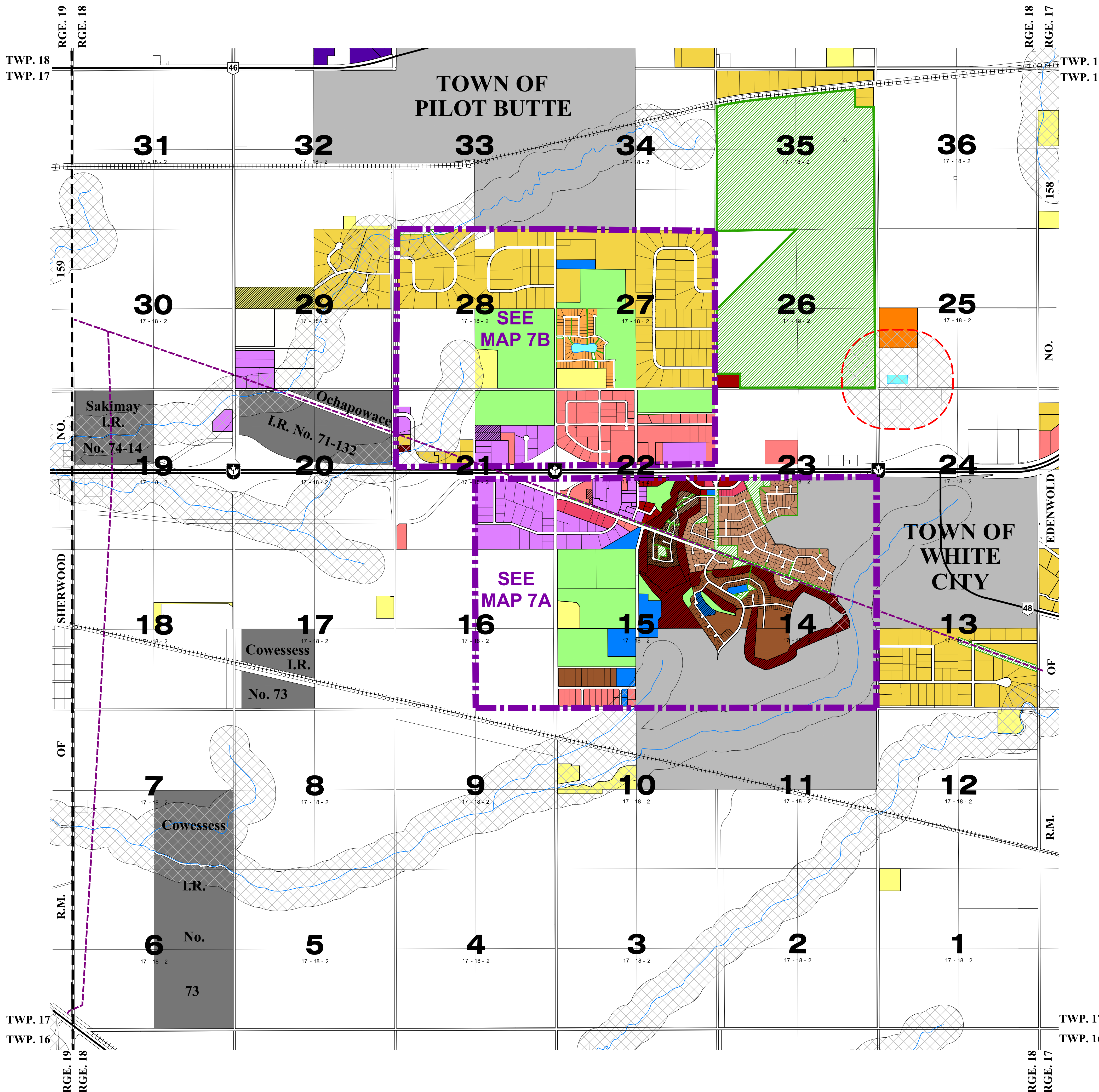
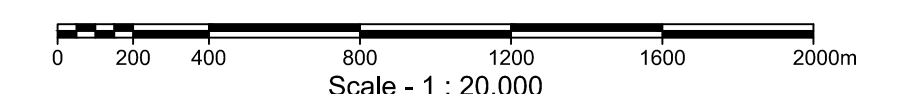

GeoVerra Inc.
Toll Free: 1-800-465-6233
www.geoverra.com

Initials: RH - SA / MDB
Client File:
Job No.: 21-A0360-003 (209466)
Drawing No.: 21-A0360-003-RM_R4

Refer to Zoning Map 7 for the boundaries of this map

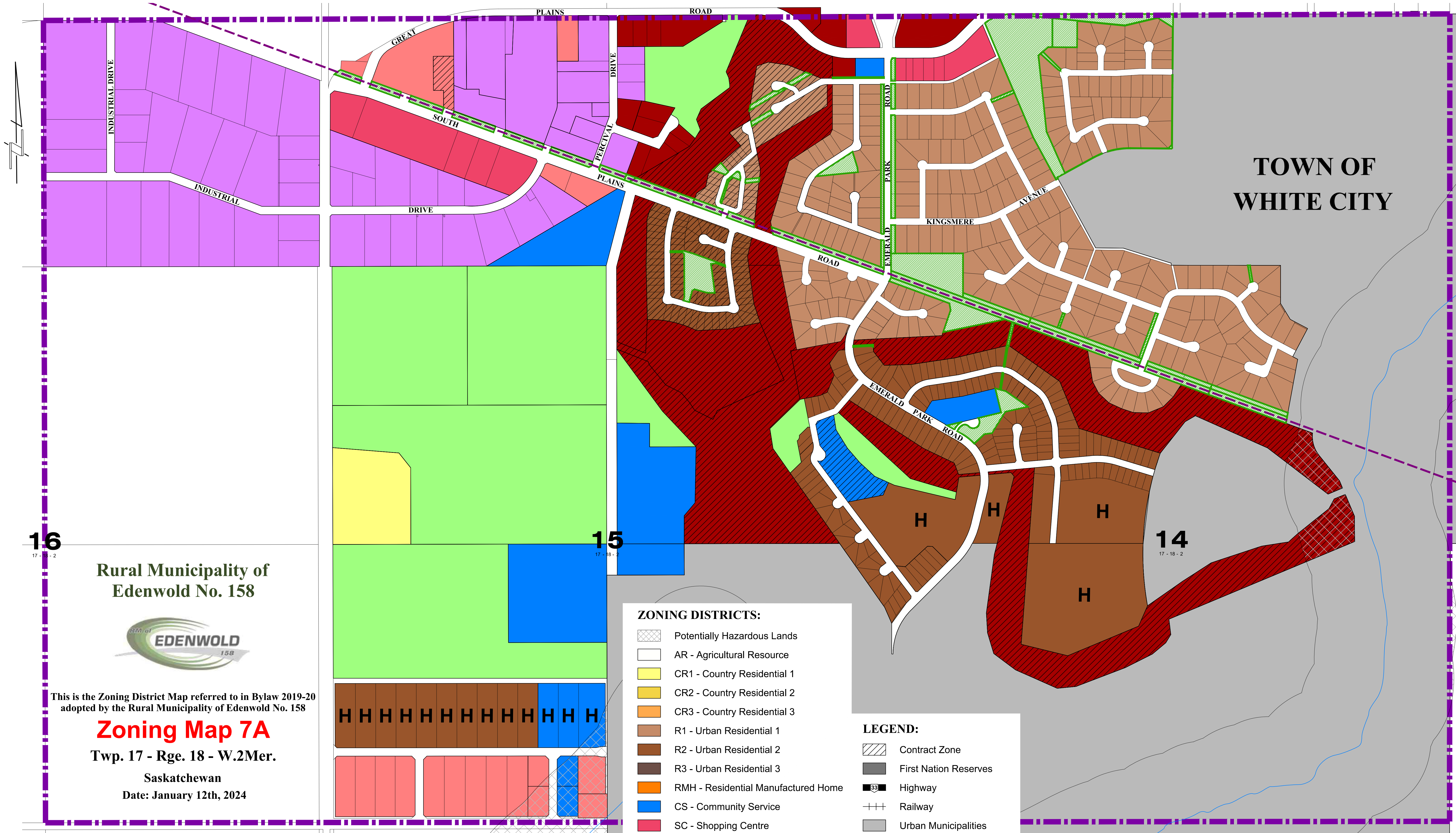

TOWN OF WHITE CITY

16
17 - 18 - 2
Rural Municipality of Edenwold No. 158



This is the Zoning District Map referred to in Bylaw 2019-20 adopted by the Rural Municipality of Edenwold No. 158

Zoning Map 7A

Twp. 17 - Rge. 18 - W.2Mer.
Saskatchewan
Date: January 12th, 2024

HHHHHHHHHHHHHHH
HHHHHHHHHHHHHHH

- ZONING DISTRICTS:**
- Potentially Hazardous Lands
 - AR - Agricultural Resource
 - CR1 - Country Residential 1
 - CR2 - Country Residential 2
 - CR3 - Country Residential 3
 - R1 - Urban Residential 1
 - R2 - Urban Residential 2
 - R3 - Urban Residential 3
 - RMH - Residential Manufactured Home
 - CS - Community Service
 - SC - Shopping Centre
 - HPC - High Profile Commercial
 - COM1 - General Commercial
 - IND1 - General Industrial
 - EHI - Extraction & Heavy Industrial
 - FD - Future Development

- LEGEND:**
- Contract Zone
 - First Nation Reserves
 - Highway
 - Railway
 - Urban Municipalities
 - Watercourse
 - Waterbody
 - Recreation Area
 - R.M. Boundary
 - Buried Distribution Line

Note: The information contained on this map is for reference only.

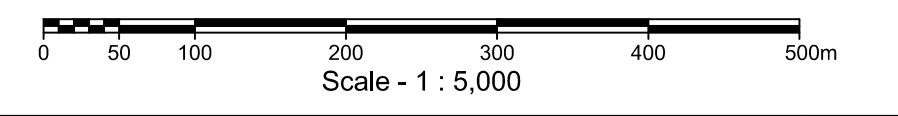

GeoVerra Inc.
Toll Free: 1-800-465-6233
www.geoverra.com

Initials: RH - SA / MDB
Client File:
Job No.: 21-A0360-003 (209466)
Drawing No.: 21-A0360-003-RM_R4

Refer to Zoning Map 7 for the boundaries of this map

Rural Municipality of Edenwold No. 158



This is the Zoning District Map referred to in Bylaw 2019-20 adopted by the Rural Municipality of Edenwold No. 158

Zoning Map 7B

Twp. 17 - Rge. 18 - W.2Mer.

Saskatchewan

Date: January 12th, 2024

LEGEND:

- Contract Zone
- First Nation Reserves
- Highway
- Railway
- Urban Municipalities
- Watercourse
- Waterbody
- Recreation Area
- Buried Distribution Line
- Compressor Station
- Gas Cavern
- R.M. Boundary

ZONING DISTRICTS:

- Potentially Hazardous Lands
- AR - Agricultural Resource
- CR1 - Country Residential 1
- CR2 - Country Residential 2
- CR3 - Country Residential 3
- R1 - Urban Residential 1
- R2 - Urban Residential 2
- R3 - Urban Residential 3
- RMH - Residential Manufactured Home
- CS - Community Service
- SC - Shopping Centre
- HPC - High Profile Commercial
- COM1 - General Commercial
- IND1 - General Industrial
- EHI - Extraction & Heavy Industrial
- FD - Future Development

Note: The information contained on this map is for reference only.

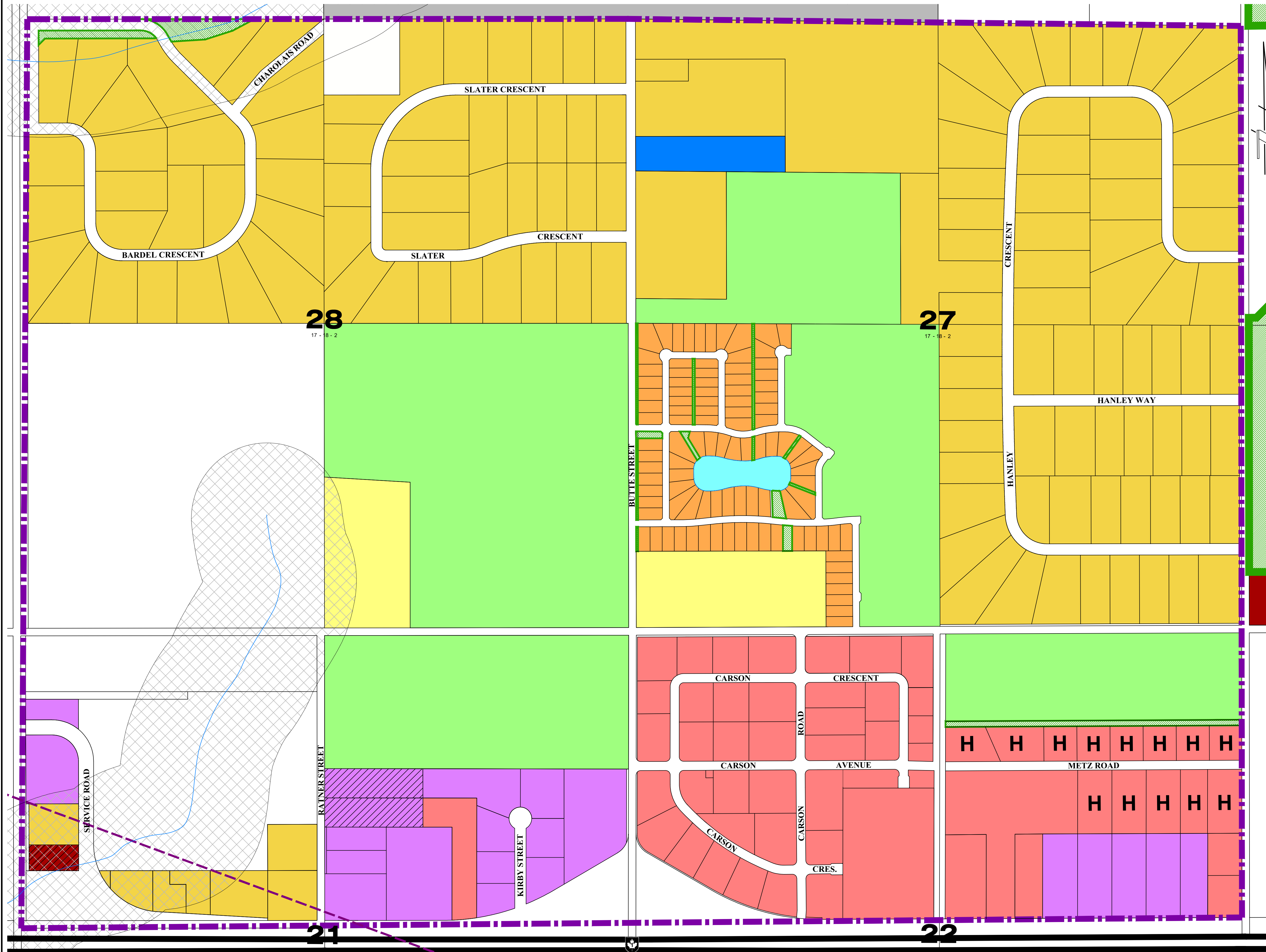
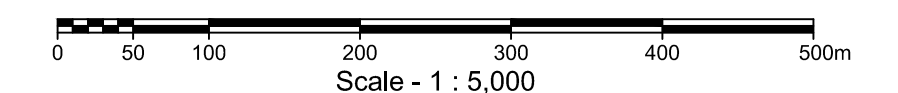

GeoVerra Inc.
Toll Free: 1-800-465-6233
www.geoverra.com

Initials: RH - SA / MDB
Client File:
Job No.: 21-A0360-003 (209466)
Drawing No.: 21-A0360-003-RM_R4



This is the Zoning District Map referred to in Bylaw 2019-20 adopted by the Rural Municipality of Edenwold No. 158

Zoning Map 8

Twp. 17 - Rge. 17 - W.2Mer.

Saskatchewan

Date: January 12th, 2024

LEGEND:

- Contract Zone
- First Nation Reserves
- Highway
- Railway
- Urban Municipalities
- Watercourse
- Waterbody
- Recreation Area
- Buried Distribution Line
- Compressor Station
- Gas Cavern
- R.M. Boundary

ZONING DISTRICTS:

- Potentially Hazardous Lands
- AR - Agricultural Resource
- CR1 - Country Residential 1
- CR2 - Country Residential 2
- CR3 - Country Residential 3
- R1 - Urban Residential 1
- R2 - Urban Residential 2
- R3 - Urban Residential 3
- RMH - Residential Manufactured Home
- CS - Community Service
- SC - Shopping Centre
- HPC - High Profile Commercial
- COM1 - General Commercial
- IND1 - General Industrial
- EHI - Extraction & Heavy Industrial
- FD - Future Development
- Direct Control District 4 - Jameson

Note: The information contained on this map is for reference only.

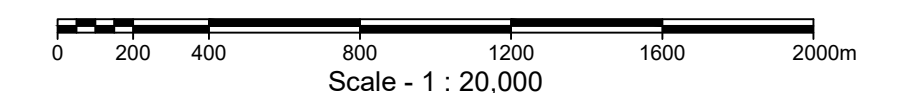

GeoVerra Inc.
Toll Free: 1-800-465-6233
www.geoverra.com

Initials: RH / SA / MDB
Client File:
Job No.: 21-A0360-003 (209466)
Drawing No.: 21-A0360-003-RM_R4

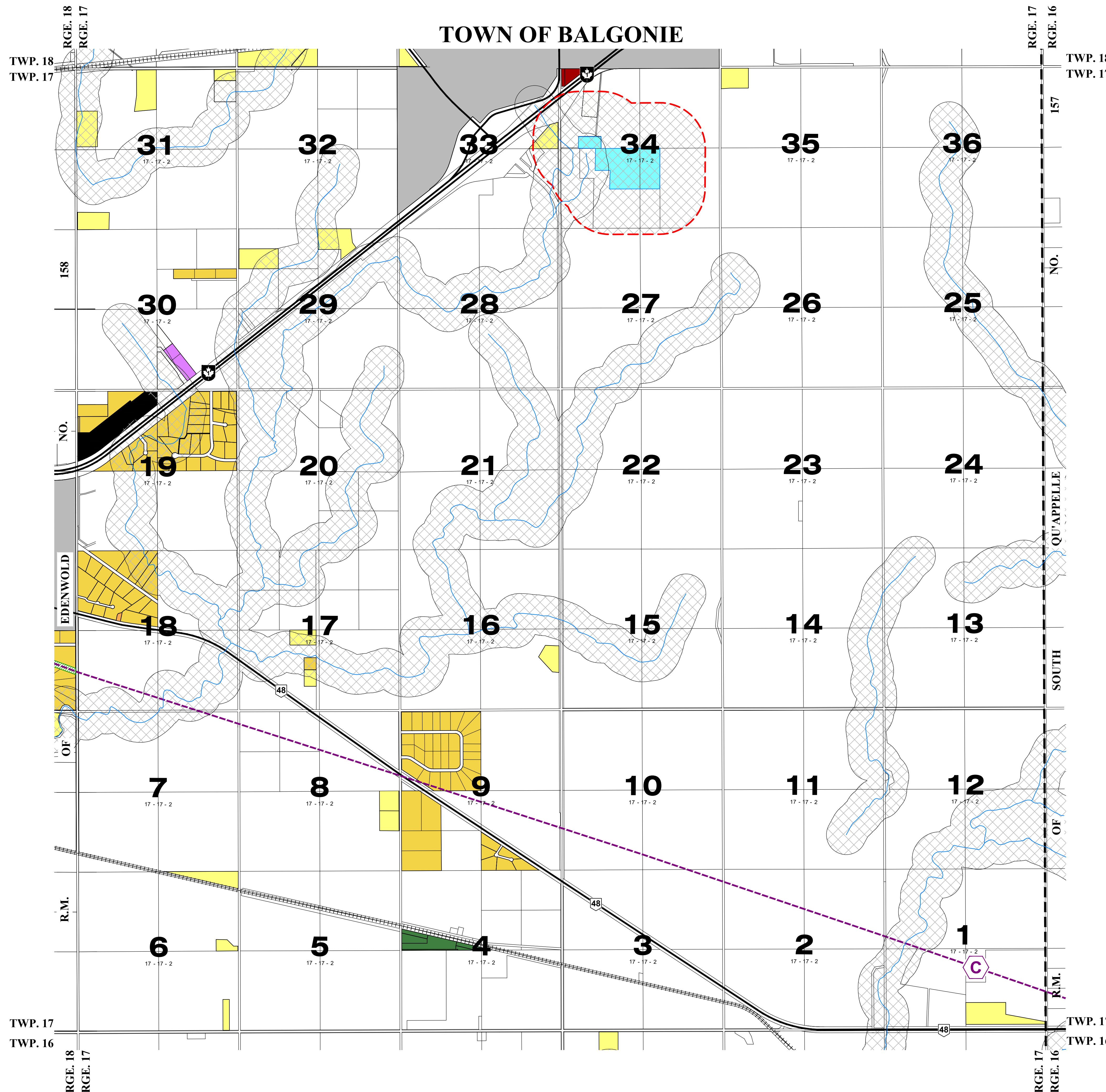

Rural Municipality of Edenwold No. 158



This is the Zoning District Map referred to in Bylaw 2019-20 adopted by the Rural Municipality of Edenwold No. 158

Zoning Map 9

Twp. 16 - Rge. 18 - W.2Mer.

Saskatchewan

Date: January 12th, 2024

LEGEND:

- Contract Zone
- First Nation Reserves
- Highway
- Railway
- Urban Municipalities
- Watercourse
- Waterbody
- Recreation Area
- Buried Distribution Line
- Compressor Station
- Gas Cavern
- R.M. Boundary

ZONING DISTRICTS:

- Potentially Hazardous Lands
- AR - Agricultural Resource
- CR1 - Country Residential 1
- CR2 - Country Residential 2
- CR3 - Country Residential 3
- R1 - Urban Residential 1
- R2 - Urban Residential 2
- R3 - Urban Residential 3
- RMH - Residential Manufactured Home
- CS - Community Service
- SC - Shopping Centre
- HPC - High Profile Commercial
- COM1 - General Commercial
- IND1 - General Industrial
- EHI - Extraction & Heavy Industrial
- FD - Future Development
- Direct Control District 2 - Richardson

Note: The information contained on this map is for reference only.

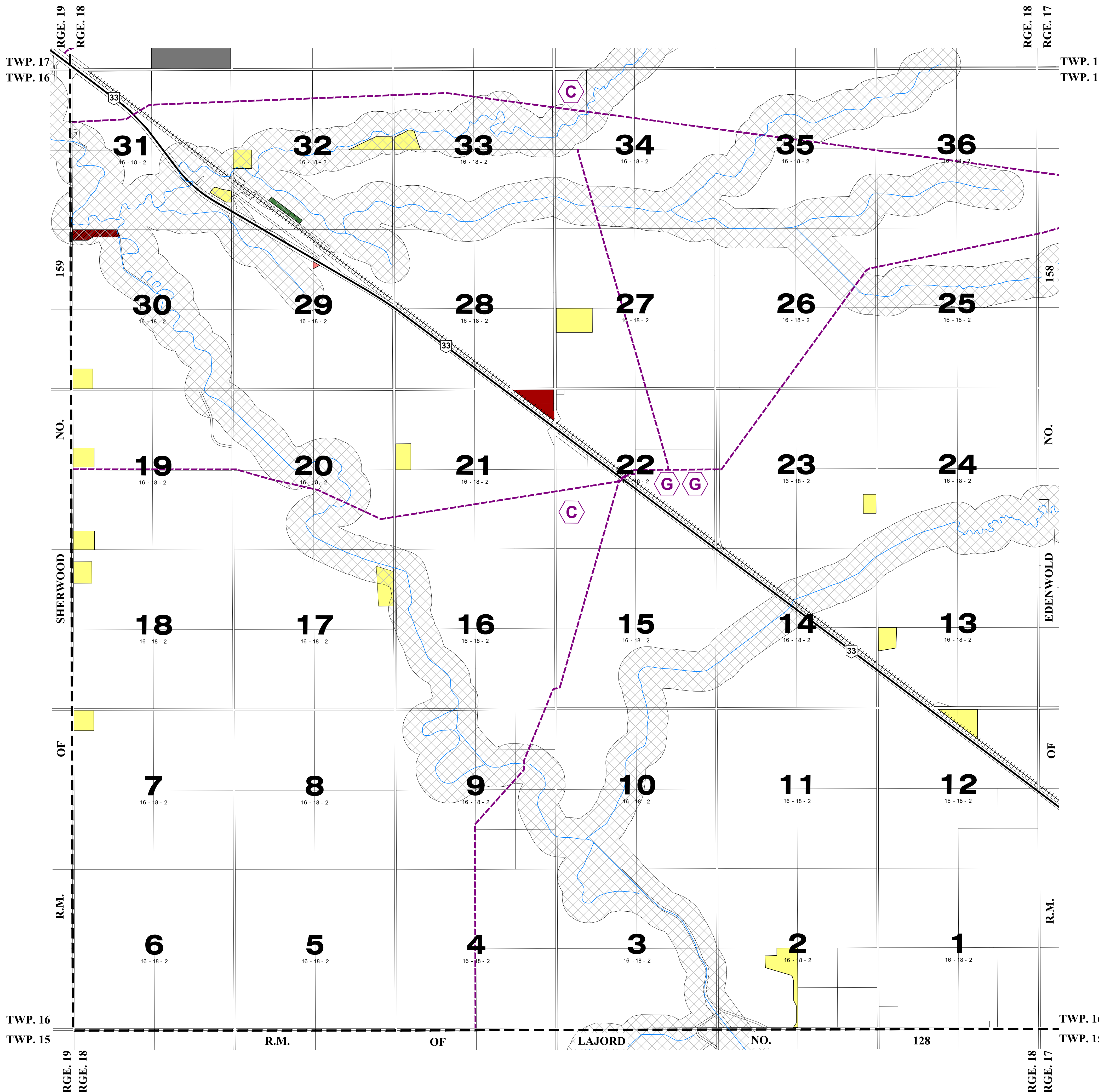
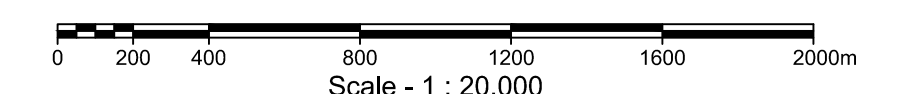

Rural Municipality of Edenwold No. 158



This is the Zoning District Map referred to in Bylaw 2019-20 adopted by the Rural Municipality of Edenwold No. 158

Zoning Map 10

Twp. 16 - Rge. 17 - W.2Mer.

Saskatchewan

Date: January 12th, 2024

LEGEND:

- Contract Zone
- First Nation Reserves
- Highway
- Railway
- Urban Municipalities
- Watercourse
- Waterbody
- Recreation Area
- Buried Distribution Line
- Compressor Station
- Gas Cavern
- R.M. Boundary

ZONING DISTRICTS:

- Potentially Hazardous Lands
- AR - Agricultural Resource
- CR1 - Country Residential 1
- CR2 - Country Residential 2
- CR3 - Country Residential 3
- R1 - Urban Residential 1
- R2 - Urban Residential 2
- R3 - Urban Residential 3
- RMH - Residential Manufactured Home
- CS - Community Service
- SC - Shopping Centre
- HPC - High Profile Commercial
- COM1 - General Commercial
- IND1 - General Industrial
- EHI - Extraction & Heavy Industrial
- FD - Future Development
- Direct Control District 3 - Kathrinthal

Note: The information contained on this map is for reference only.

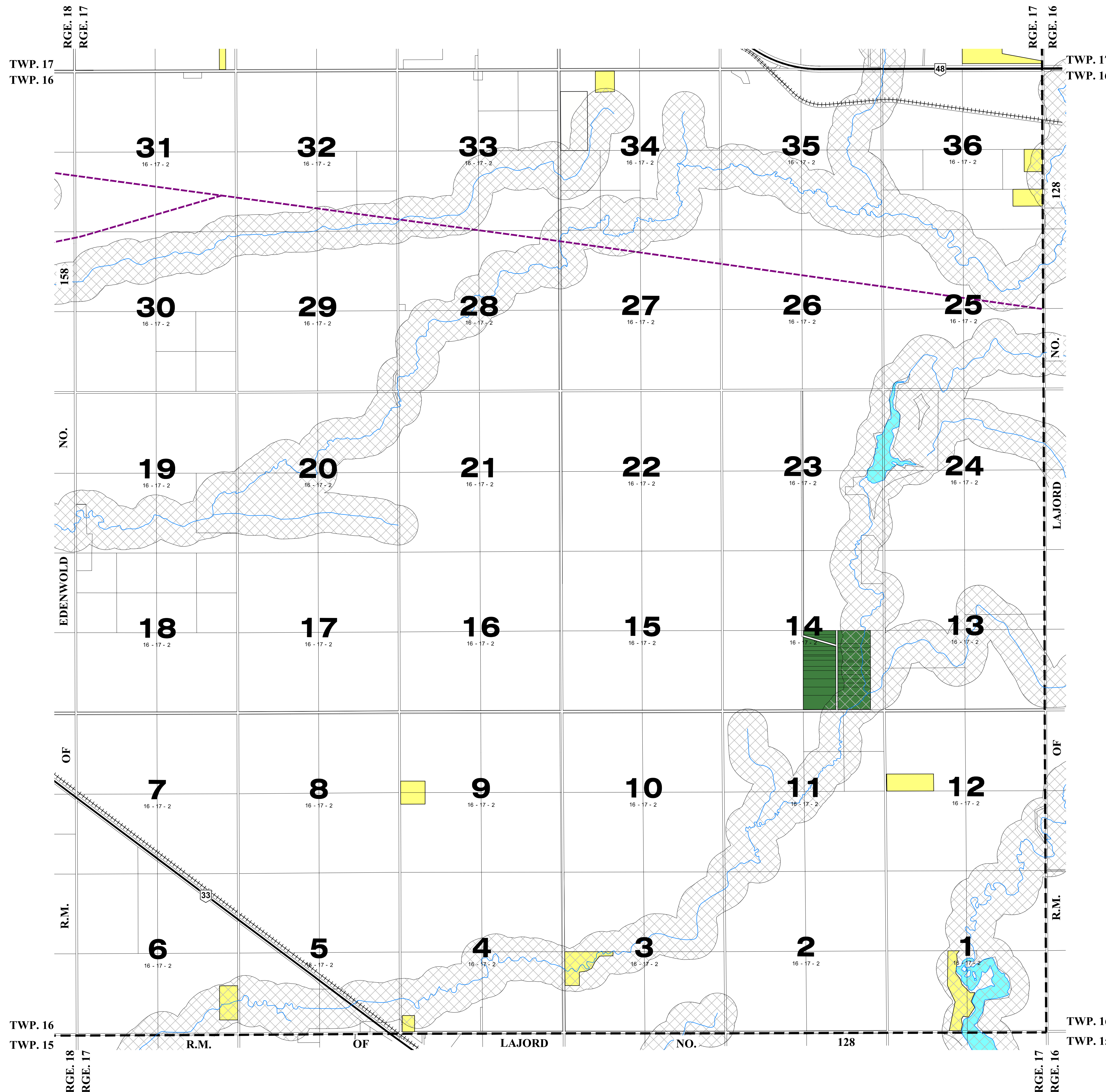
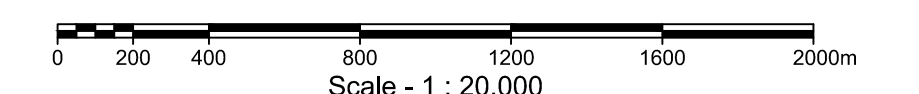

GeoVerra Inc.
Toll Free: 1-800-465-6233
www.geoverra.com

Initials: RH - SA / MDB
Client File:
Job No.: 21-A0360-003 (209466)
Drawing No.: 21-A0360-003-RM_R4